

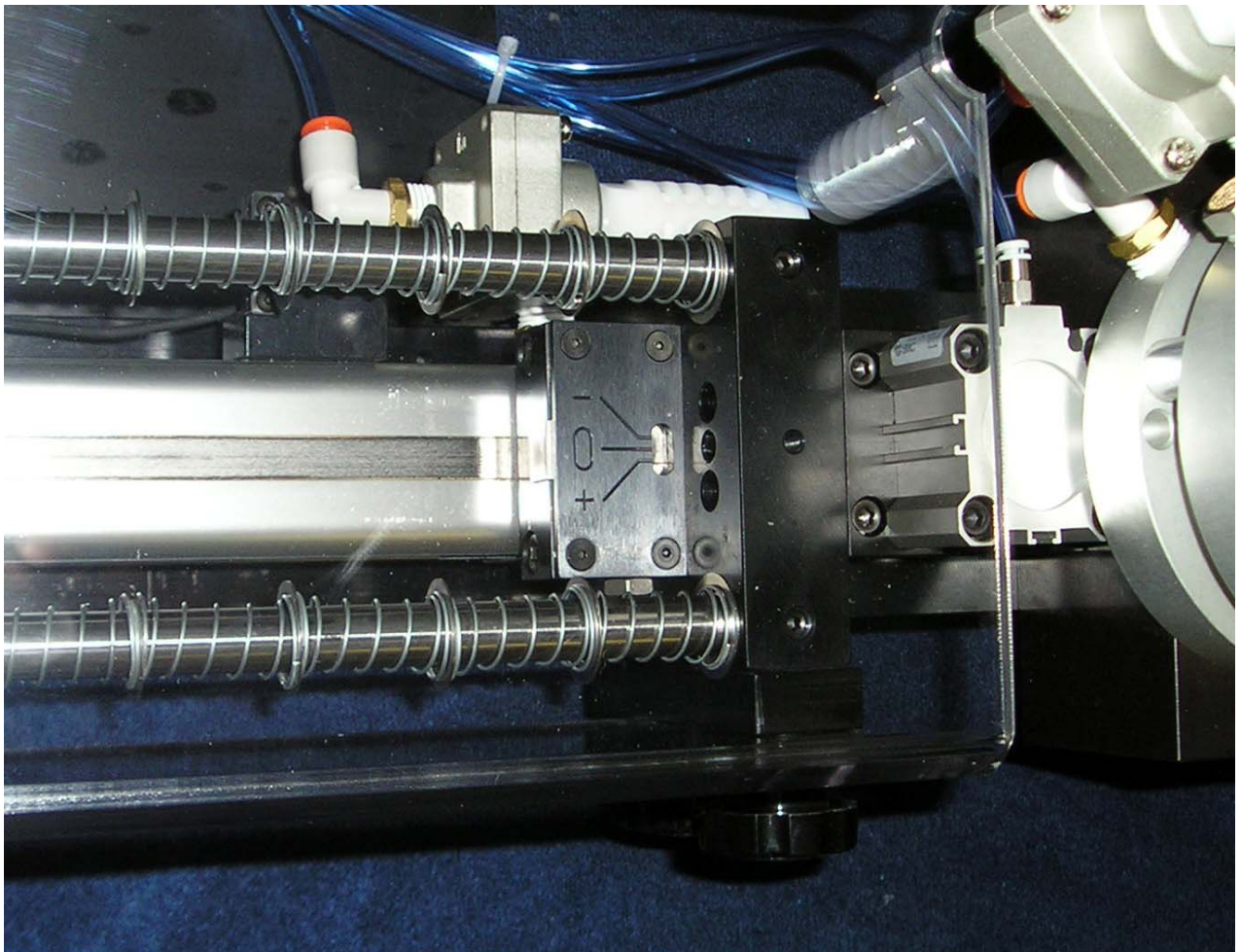

Addendum: for SF&C #02

OPTIONAL FINE ADJUST ACCESSORY





SF&C System Options

Fine Adjustment Device (FAD)

Adjustments down to .0002"

The TAK **Fine Adjustment Device** option is designed to allow the user to more precisely set the cut length tolerance "band" on the Series #02 SF&C system.

The **FAD** option is comprised of a fully integrated mounting block with precision guide rails, locking fine adjustment screw, and position indicator plate. The **FAD** is positioned just forward of the system's rear gripper and cutter head and either retracts or extends the "dead stop" point of the stroking mechanism.

Operation – Once the basic cut length is set on the SF&C system the operator simply measures any cut piece to determine where the piece fits within the tolerance "bell curve" and either turns the adjustment screw in or out to bring the cut length to the center value. Each ¼ turn of the screw is equal to .0002" of adjustment. The **FAD** eliminates the need for the operator to have to stop the system and manually reset the cut length tolerance.

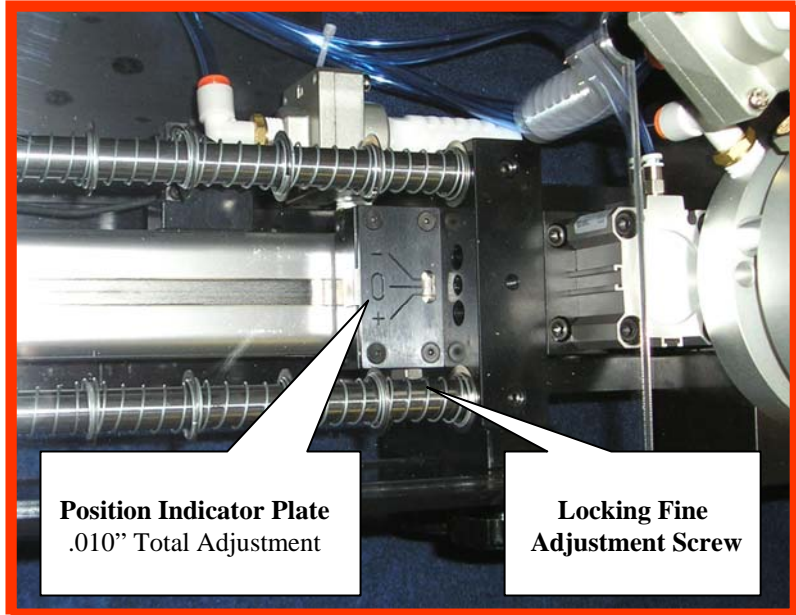

Series #02 SF&C System

With "Pro-Pack" Option

MATERIAL REQ'D.

R.C.

PART LISTING

#	PN #	DESCRIPTION	QTY.
1	4010-228	BODY COVER	1
2	9020-040	COMPRESSION SPRING	1
3	4010-226	REAR WEDGE BLOCK	1
4	4010-227	FRONT WEDGE STOP BLOCK	1
5	9020-041	COMPRESSION SPRING	2
6	4010-225	FINE ADJUST BODY	1
7	906-009	1/2-28 JAM NUT	1
8	9003-105	1/2-28 X 1" SET SCREW	1
9			

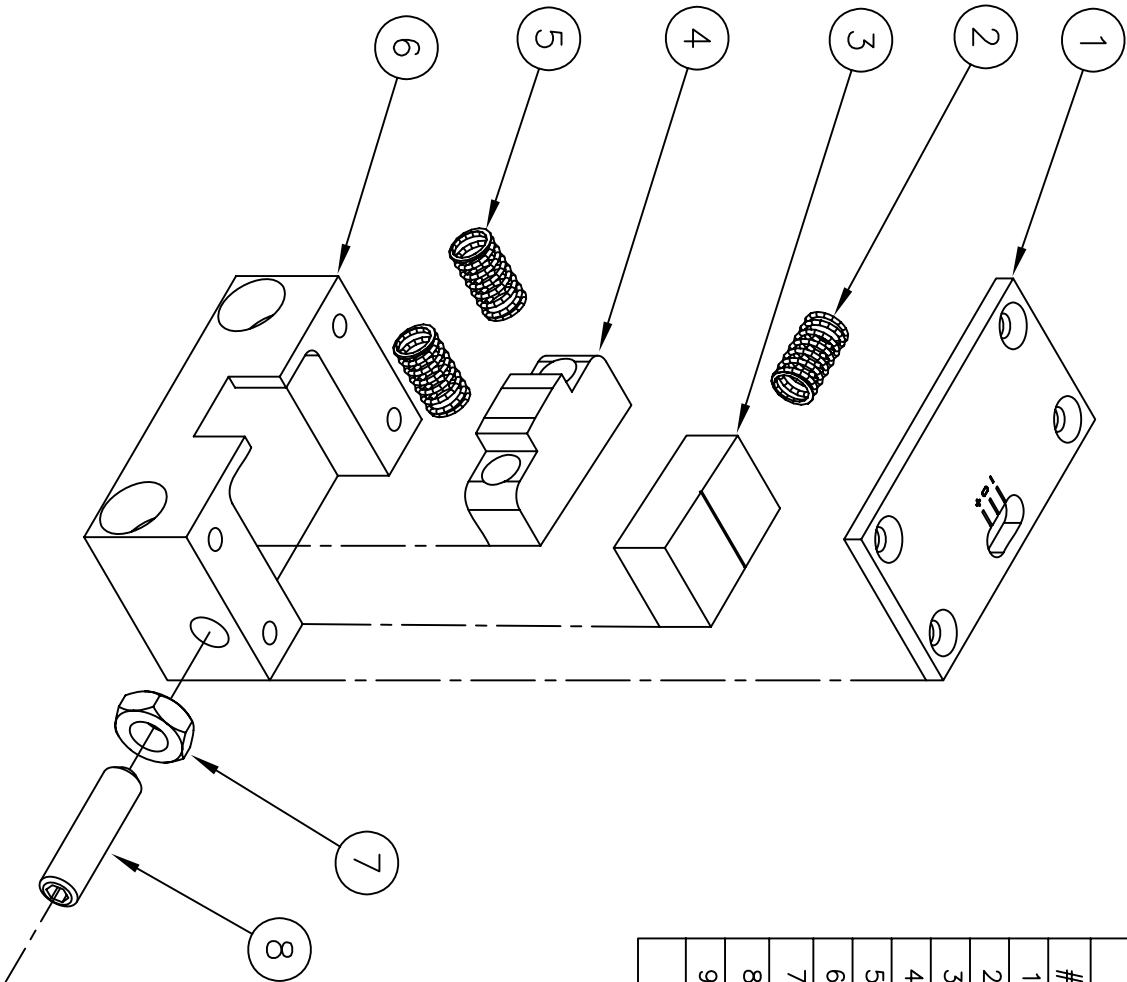

REV	ECN	CHG BY	DATE

TOLERANCE UNLESS OTHERWISE STATED

Δ	$\pm 3^\circ$	FRACT +/-	1/16
\perp	± 0.0003	X	$\pm .032$
\odot	± 0.0002	.XX	$\pm .015$
\oplus	± 0.0005	.XXX	$\pm .005$
\equiv	± 0.0005	.XXXX	$\pm .0005$

CAD	DRAWING / PART NO.
DWN GDH	4010-001
CHK	PART NAME
SCALE	FINE ADJUST ASSY
DATE 112205	CUSTOMER

